

12th Annual Meeting
International Association of Medical Science Educators

Call for Exhibitors and Commercial Supporters



July 25-29, 2008
Hilton City Center
Salt Lake City Utah USA

Co-Hosted by:

University of Utah
and
Slice of Life

Meeting Facts

As partners in medical education and healthcare, we cordially invite all corporate entities to participate in this program with a display of your educational products and services. More than 350 registrants representing over 30 countries will be attending this academic meeting.

Who Will Attend?

This event, which is being hosted by The University of Utah and the Slice of Life, will explore strategies for teaching and learning the fundamental sciences of medicine. It is directed toward course and clinical clerkship directors; basic scientists and academic physicians; directors and deans; deans for medical education, academic affairs, faculty development, and CME; educational psychologists; and all those who have interest in more appropriately integrating science within the medical curriculum. As global interdisciplinary events, IAMSE annual association meetings attract participants from all over the world representing all subject disciplines throughout human, veterinary, and dental medicine.

Who Should Exhibit?

- * Manufacturers and suppliers of teaching aids used in the classroom including PDAs, computers, simulators and other computer related teaching devices
- * Publishers of medical and basic medical science textbooks, books and journals
- * Developers of course management systems, case bank resource tools, web based testing solutions, test question banks
- * Manufacturers and suppliers of audience response systems and other student assessment tools
- * Suppliers of distance learning applications
- * Manufacturers and suppliers of laboratory equipment including virtual microscopes, sky-cam's, interactive software
- * National organizations representing medical science disciplines

Exhibitor Information

Patron – \$2,000

- * Breakout room for an interactive demonstration during the Technology Showcase
- * Two registration fees will be waived including all meals, breaks, receptions, social event and dinner
- * Two draped tables with two chairs
- * Company Brochure or Literature sheet in each registrant's packet
- * Company logo on the [meeting website](#) *with hyperlink* and in the published conference proceedings
- * Recognition in the syllabus including a 100 word marketing statement
- * Complete directory of participants - including e-mail addresses - provided in electronic format

Supporter – \$1,200

- * One registration fee will be waived including all meals, breaks, receptions, social event and dinner
- * One draped table with two chairs is provided
- * Company Brochure or Literature sheet in each registrant's packet
- * Company logo on the [meeting website](#) *with hyperlink* and in the published conference proceedings
- * Recognition in the syllabus including a 100 word marketing statement

Contributor—\$750

- * One unmanned display table where your materials will be on display **OR**
- * Insert materials in each registrant's packet (Literature sheet, pens, flyers, trinkets, etc)
- * Company logo on the [meeting website](#) *with hyperlink* and in the published conference proceedings
- * Recognition in the syllabus including a 100 word marketing statement

Non-Profit Discipline Based Society —\$750

- * One registration fee will be waived
- * One eight-foot draped table with two chairs is provided
- * Company logo on the [meeting website](#) *with hyperlink* and in the published conference proceedings
- * Recognition in the syllabus including a 100 word marketing statement

Additional Sponsorship Opportunities

Opening Reception—\$10,000
One Luncheon—\$8,000
Refreshment Breaks—\$3,000
Participation in our Silent Auction—Varied

All of the Faculty Development Courses—\$10,000
One Continental Breakfast—\$6,000
Speaker or Program Feature—\$5,000
Full Page ad in Syllabus—\$1,000 (black & white)

Daily Schedule of Events—(Preliminary)

Saturday, July 26, 2008

8:00 am — 6:00 pm	Exhibitor Move In
8:00 am — 6:00 pm	Pre-Conference Courses & Workshops
6:30 pm — 7:00 pm	Opening Ceremony
7:00 pm — 8:30 pm	Opening Reception with Exhibitors

Sunday, July 27, 2008

7:00 am — 8:00 am	Continental Breakfast with Exhibit & Poster Viewing
8:00 am — 10:00 am	General Sessions
9:30 am — 10:30 am	Exhibitor & Poster Viewing
10:30 am — 12:00 pm	General Sessions
12:00 pm — 1:30 pm	Lunch
1:30 pm — 2:30 pm	General Sessions
2:30 pm — 4:00 pm	Poster & Exhibitor Viewing
4:00 pm — 5:00 pm	General Sessions

Monday, July 28, 2008

7:00 am — 8:00 am	Continental Breakfast with Exhibit & Poster Viewing
8:00 am — 9:30 am	General Sessions
9:30 am — 10:30 am	Poster & Exhibitor Viewing
10:30 am — 12:00 pm	General Sessions
12:00 pm — 1:00 pm	Lunch
1:00 pm — 2:00 pm	Poster & Exhibitor Viewing
2:00 pm — 4:00 pm	General Session
4:00 pm — 6:00 pm	Interactive Technology Session

Tuesday, July 29, 2008

12:00 pm — 1:30 pm	Exhibitor Breakdown and Move out
--------------------	----------------------------------

** Please note, the final schedule will be emailed to all vendors in May, 2008

Hotel Information

Hilton City Center
255 South West Temple
Salt Lake City UT 84101 USA

IAMSE Meeting Room rate:
Single \$154
Double \$169

Tel: (801) 328-2000
Fax: (801) 359-2938

For Reservations Call:

(801) 328-2000
or toll free 877-776-4936

You must ask for the Group rate for the International Association of Medical Science Educators

HILTON SALT LAKE CITY CENTER - LOBBY LEVEL

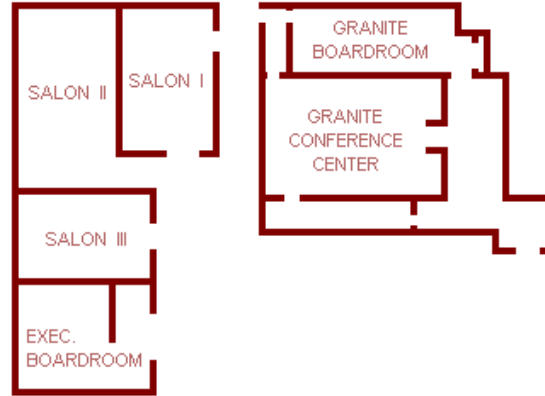

HILTON SALT LAKE CITY CENTER - SECOND LEVEL

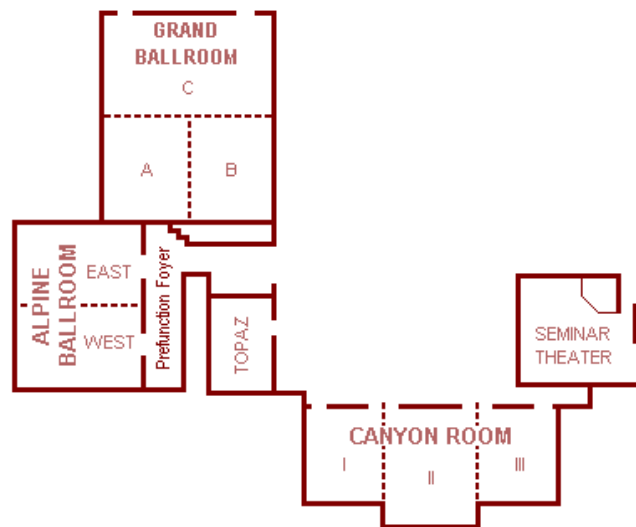

Terms, Conditions & General Rules

Application Deadline and Fees—Applications for exhibit space are considered on a first-come, first serve basis. Given limited space in the exhibit area, it is recommended that your organization submit the completed application form as soon as possible. The deadline for receipt of the application as full payment is 5:00 pm EST, May 1, 2008. Rates will increase \$250 for all applications postmarked after May 1, 2008. Exhibit space is assigned by IAMSE in the order that signed contracts and payments are received.

Cancellations or Reductions—Cancellation requests must be received in writing no later than June 1, 2008 and are subject to a \$250 cancellation fee per booth. If space is reduced prior to May 1, 2008, 20% of the total cost of space will be retained. If space is reduced between May 2, 2008— May 31, 2008, 50% of the total cost of the space will be retained. There are no refunds for reduction or cancellation after June 1, 2008.

Electrical Connections and Internet—Arrangements for electricity or Internet access must be made directly with the conference hotel. Details for these arrangements will be sent to the official contact person.

Exhibit Booth Representation—A company representative must be at the display at all times when the exhibit hall is open. The rate for additional representatives not included in the original registration will be \$300. All company representatives must be pre-registered.

Liability—Each exhibitor agrees to protect, save and hold Hilton City Center, IAMSE and all agents and employees thereof (hereinafter collectively called "Indemnities") forever harmless for any damages or charges imposed for violations of any law or ordinance, whether occasioned by the negligence of the Exhibitor or those holding under the Exhibitor, and further, Exhibitor shall at all times protect, defend, indemnify, save and hold harmless the indemnities against and from any and all losses, costs, damages, liability, or expenses (including attorney's fees) arising from or by reason of any accident or bodily injury or other occurrence to any person or persons, including Exhibitor, its agents, employees and business invites, which arises from or out of the exhibition premises, the hotel or any part thereof.

Shipping—All exhibitors are asked to make individual arrangements for shipping / handling. Details for shipping will be sent to the official contact person.

Non-Educational Activities—Exhibitor sponsored dinner, receptions, entertainment activities and/or meetings may not be scheduled in direct conflict with any scheduled sessions. Requests for space must be approved by IAMSE prior to contacting the Hotel.

Sound Devices / Noise Level—The noise level from any product demonstration or sound system must be kept to a minimum, not to interfere with other exhibits.

Subletting or Sharing of Space—No subletting or sharing of booth space is permitted.

Application

Organization _____

Address _____

City State Zip _____

Exhibit Booth Participants

1. _____ Title: _____

2. _____ Title: _____

* Please attach or e-mail a brief company description (100 words or less) of your organization's products and services. This description will be printed in conference syllabus

* Please send a copy log in a high resolution tif or jpg format (300 dpi) to be used as recognition at the meeting and in the conference syllabus.

* Please read the Exhibitor Information and Conditions of Exhibitor Agreement carefully before sending in this application/contract for Exhibit Space. Exhibitor booth assignments are on a first-come, first-serve basis. There are a limited number of tabletops for not-profit discipline societies.

Agreement: We hereby submit application for exhibit space at the 11th annual IAMSE meeting. We agree to abide by the terms and conditions set forth under terms, conditions & general rules.

Name: _____

Signature: _____

Method of Payment: Check Credit Card (Master Card / Visa) Amount: _____

Card #: _____ Expires: _____

Exhibit Fee: _____

Sponsor Fees: _____

Add'l Registrants @

\$300 Each: _____

Exhibit Fees:

- Patron—\$2,000
- Supporter—\$1,200
- Contributor—\$750
- Non-Profit \$750

Sponsor Fees:

- Opening Reception—\$10,000
- One Luncheon—\$8,000
- One Continental Breakfast—\$6,000
- All of the Faculty Development Courses—\$10,000

Total Fees: _____

- Full Page ad in Syllabus—\$1,000 (b&w)
- One Refreshment Break—\$3,000
- Speaker or Program Feature—\$5,000
- Participation in our Silent Auction—Varied

Complete and sign this form and return with full payment to IAMSE, One Crested Butte Huntington, WV 25705

For Additional Information Please Contact:

Julie K. Hewett, CMP
Association Manager
Tel: (304) 733 1270
Fax: (304) 733 6203

Email: julie@iamse.org

Visit the IAMSE Conference Website at iamseconference.org

Program Information

The final program brochure will be available both online and in print in March 2008

Future Meeting Dates:

July, 2009— Leiden, The Netherlands

IAMSE
1 Crested Butte
Huntington, WV 25705 USA